

REMAINDER OF 81.25 ACRES
6/14/0, D.R.

GEORGE BURRELL
TRACT 9 60.00 ACRES (CALLED)
341/224, D.R.

NOTES

1. ALL VISIBLE EASEMENTS AND EASEMENTS OF RECORD AS REFLECTED ON TITLE REPORT FROM WASHINGTON COUNTY ABSTRACT COMPANY, OR NO. 2816000438, EFFECTIVE DATE OF MAY 29, 2006, ISSUED MAY 11, 2006, ARE SHOWN HEREON.
2. DEED RESEARCH PERFORMED BY LIPPLANT SURVEYORS, INC.
3. ALL BEARINGS ARE BASED UPON THE PREVIOUS DEED OF 31,871 ACRES.
4. LARGER VISIBLE AND APPARENT IMPROVEMENTS ARE BEING SHOWN, NO ATTEMPT HAS BEEN MADE TO SHOW UNDEVELOPED IMPROVEMENTS IF IN EXISTENCE.
5. THIS SURVEY DOES NOT PROVIDE ANY DETERMINATION CONCERNING WETLANDS, FAULT DIRECTED BY THE CLIENT OR THROUGH THE PROVISION TO AN OTHER SURVEYOR.
6. AGRICULTURE AND SOIL USE ARE SHOWN HEREON AND ON THE METES AND BOUNDS DEEDS AND DEEDS OF RECORD AS REFLECTED ON TITLE REPORT FROM WASHINGTON COUNTY ABSTRACT COMPANY, OR NO. 2816000438, EFFECTIVE DATE OF MAY 29, 2006, ISSUED MAY 11, 2006, ARE SHOWN HEREON.
7. THIS DOCUMENT IS COPYRIGHT PROTECTED WITH A PRODUCTION DATE AS INDICATED BELOW.
8. NO BUILDING AND PERSON SET BACK LINES.

TO: WASHINGTON COUNTY ABSTRACT COMPANY, AND CAPITAL FARM CREDIT, FROM THIS PLAT HEREBY CERTIFY THAT THIS SURVEY WAS MADE ON THE GROUND AND THAT THE BEARINGS AND DISTANCES WERE MEASURED BY ME OR THAT THE PROFESSIONAL SURVEYORS STANDARDS AND SPECIFICATIONS FOR A CATEGORY 1A, CONDITION 1 SURVEY, WERE FOLLOWED. THIS SURVEY IS UNDERSTOOD TO BE AN EXPRESSION OF MY BEST KNOWLEDGE, INFORMATION, AND BELIEF.

ROBERT A. LIPHANT
REGISTERED PROFESSIONAL LAND SURVEYOR NO. 1833
DATE SURVEYED: 2/27/07
NOT VALID WITHOUT SURVEYOR'S ORIGINAL SIGNATURE.
A SEPARATE METES AND BOUNDS DESCRIPTION WAS PREPARED IN CONJUNCTION WITH THIS SURVEY.
THIS DOCUMENT IS COPYRIGHT PROTECTED WITH A PRODUCTION DATE OF 06/08/05

SCALE: 1" = 400'



LIPPLANT SURVEYORS, INC.

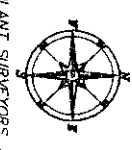

BOUNDARY SURVEY
31.70 ACRES OUT OF CALLED 81.25 ACRES IN THE
M.A. EARLY SURVEY, ABSTRACT NO. 40
VOLUME 646, PAGE 001, DEED RECORDS
WASHINGTON COUNTY, TEXAS

DATE: 2/27/07
DRAWN BY: [blank]
CHECKED BY: [blank]
APPROVED BY: [blank]
PROJECT NO.: [blank]

PATT L PERESSINI & BARBARA W. JUSTIN